

Fixed gas detectors - 24 hour monitoring

GTQ-BS01 & GTQ-BS02 fixed gas detector is designed for industrial and commercial use. By adopting high-performance gas sensor and MCU technology, combined with sophisticated SMT manufacturing process, this detector has good repeatability, high accuracy and long lifespan.

ADVANTAGES



GTQ-BS01 Fixed Gas Detector

FEATURES

- High measurement accuracy, stable performance and long service life
- 4-20mA analog output or FBUS digital output
- Non-contact operation by infrared remote control
- Smart sensor module, free of calibration, easy to maintain

APPLICATION

This detector is widely used in petroleum, petrochemical, chemical production plant areas, petroleum and natural gas gathering and transportation, refueling/gas stations, municipal administration, metallurgy, electric power and other places where flammable gas exists.

SPECIFICATIONS

Measuring gas	Combustible gas	Operating temperature	-40~70°C
Sample method	Diffuse naturally	Humidity	≤95%RH (no condensation)
Power	DC24V±6V, ≤2.5W	Ambient pressure	86KPa~106KPa
Response time	T90≤20s	Ex grade	Ex d IIC T6 Gb / Ex tD A21 IP67 T80°C
Electrical output	4-20mA or PBUS	Ingress protection	IP67
Relays	1 relay (free contact)	Enclosure material	Aluminium alloy
Operation by	IR remote control	Cable entry	NPT3/4
State indication	Yellow--Fault, Red--Alarm, Green--Power	Dimensions & Weight	130mm x 154mm x 83mm about 1.2kg



GTQ-BS02 Fixed Gas Detector

FEATURES

- High measurement accuracy, stable performance and long service life
- 4-20mA analog output or FBUS digital output
- 2 relay outputs
- High-performance LED screen display
- Non-contact operation by infrared remote control
- Smart sensor module, free of calibration, easy to maintain

APPLICATION

This detector is widely used in gas detection in petroleum and petrochemical industries, refineries, chemical plants, metallurgical industries, power industries, and other places that may produce harmful gases to the human body.

SPECIFICATIONS

Measuring gas	Combustible gas, toxic gas	Operating temperature	LEL: -40~70°C Toxic: -20~50°C
Sample method	Diffuse naturally	Humidity	≤95%RH (no condensation)
Power	DC24V±6V, ≤2.5W	Ambient pressure	86KPa~106KPa
Response time	LEL: T90≤15s Toxic gas: T90≤30s	Ex grade	Ex d IIC T6 Gb / Ex tD A21 IP67 T80°C
Electrical output	4-20mA or PBUS	Ingress protection	IP67
Relays	2 relay (free contact)	Enclosure material	Aluminium alloy
Operation by	IR remote control	Cable entry	NPT3/4
State indication	Yellow--Fault, Red--Alarm, Green--Power	Dimensions & Weight	130mm x 154mm x 83mm about 1.2kg



Fixed gas detectors - 24 hour monitoring

BS03 Fixed Gas Detector

BS03 is a fixed gas detector installed in a place where potential gas hazard exists to measure oxygen, toxic gas and combustible gas. It shows not only the concentration of gas but also diagnostic result of the unit itself through the LED screen and LED lights and can be connected to the control panel with a standard 4-20mA analog output.

FEATURES

- BS03 measures the concentration of the flammable gas, toxic gas, oxygen and VOCs
- Explosion proof structure.
- Water and dust proof design
- Segment display to indicate readings in 4 digits.
- 3 LED lights to indicate Fault, Low alarm and High alarm
- IR remote control for setting and calibration.

APPLICATION

Steelworks, Petrochemical plants, Shipyards, Water treatment plants, Mines, Power plants, Food industry etc.

DIMENSION DRAWING

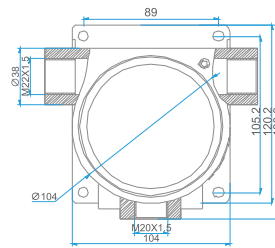

WIRING TERMINAL DIAGRAM

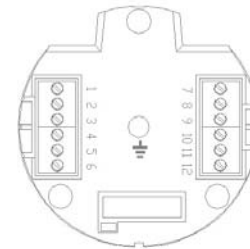

NO.	Mark	Function	Spec
1	L-Alarm	Low alarm output	Switching value
2	L-Alarm	Low alarm output	
3	24V	Power input	DC24V±25%
4	GND	Power input	
5	Iout	Current output	4~20mA
6	NC	---	---
7	H-Alarm	High alarm output	Switching value
8	H-Alarm	High alarm output	
9	24V	Power input	DC24V±25%
10	GND	Power input	
11	Iout	Current output	4~20mA
12	NC	---	---

SPECIFICATIONS

Measuring gas	Combustible	Catalytic sensor / NDIR sensor	
	Toxic gas & O2	Electrochemical sensor	
	CO2 gas	NDIR sensor	
	VOCs	PID sensor	
Measuring range	Refer to our gas list	Cable / distance	1.5 MM2, 3 wire, shielded, 1000m (maximum)
Measuring accuracy	±5%F.S.	Conduit connection	G3/4"
Sensor life	Catalytic sensor: 3 years	Mounting type	Wall mounted
	Electrochemical: 2 years (1 year for O2 sensor)	Working temperature	Toxic gas: -20°C~+50°C Combustible: -40°C~+70°C
	NDIR sensor: 5 years PID sensor: 0.6 to 1 year	Working humidity	≤95%RH (no condensation)
Measuring type	Diffuse naturally	Operation voltage	DC24V±25%
Response time	Catalytic sensor: T90≤30s	Consumption	<2W
	Electrochemical: T90≤60s	Ingress Protection	IP65
	NDIR sensor: T90≤10s PID sensor: T90≤10s	Housing material	Chamber: Aluminum alloy Sensor cover: Stainless steel
Signal output	4-20mA	Dimension and weight	162 x 208 x 103.5mm, about 2.1kg
Alarm output signal	2 programmable relays	Approval	Ex II 2G Ex db IIC T6 Gb