



RG Regulators are self-acting regulators with a double safety diaphragm. The double diaphragm allows functional usage without the need to connect to an external venting pipe.

2 Types Available : Normal Capacity (0.5 Bar)
High Capacity (2 Bar)

Spring : Replaceable & adjustable for high outlet pressure.

RG REGULATOR SERIES

TECHNICAL SPECIFICATIONS

Model	NG M3/HR	LPG KG/HR	Inlet Pressure	Outlet Pressure	Inlet - Outlet Connection
RG025	24	28	0.5 Bar	28 - 70 mBar / 120 - 300 mBar	1" - 1"
RG025-HC	50	60		28 - 70 mBar / 120 - 500 mBar	
RG025-2B	24	28	2 Bar	28 - 70 mBar / 70 - 280 mBar	
RG025-2B-HC	50	60		28 - 70 mBar / 200 - 600 mBar	
RG032-2B	300	360		28 - 70 mBar / 220 - 480 mBar	1 1/4" - 1 1/4"

DIMENSIONS (MM)

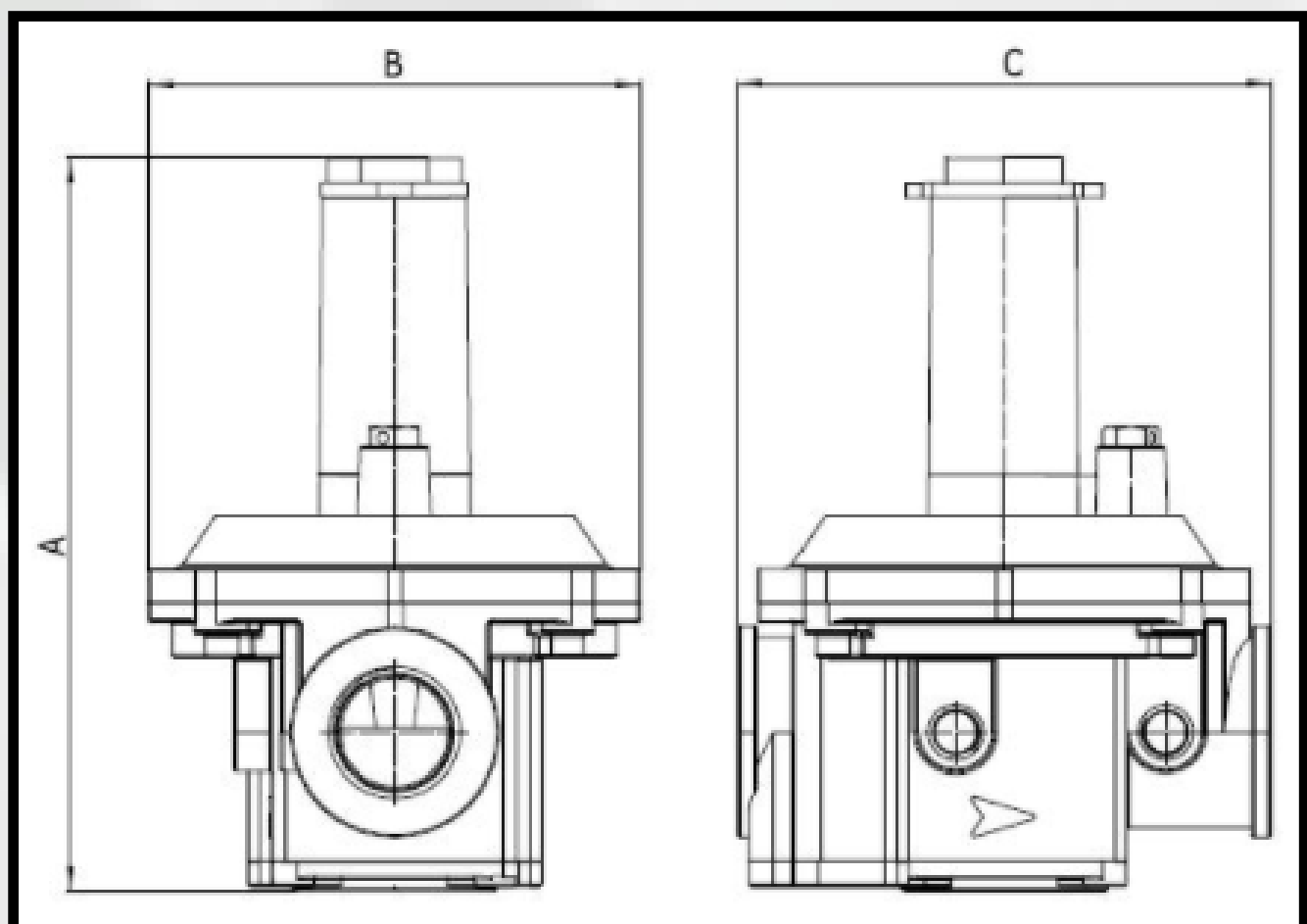

Size	A	B	C
1"	154	100	115
1 1/4"	244	194	210

INTERNAL SCHEMATIC

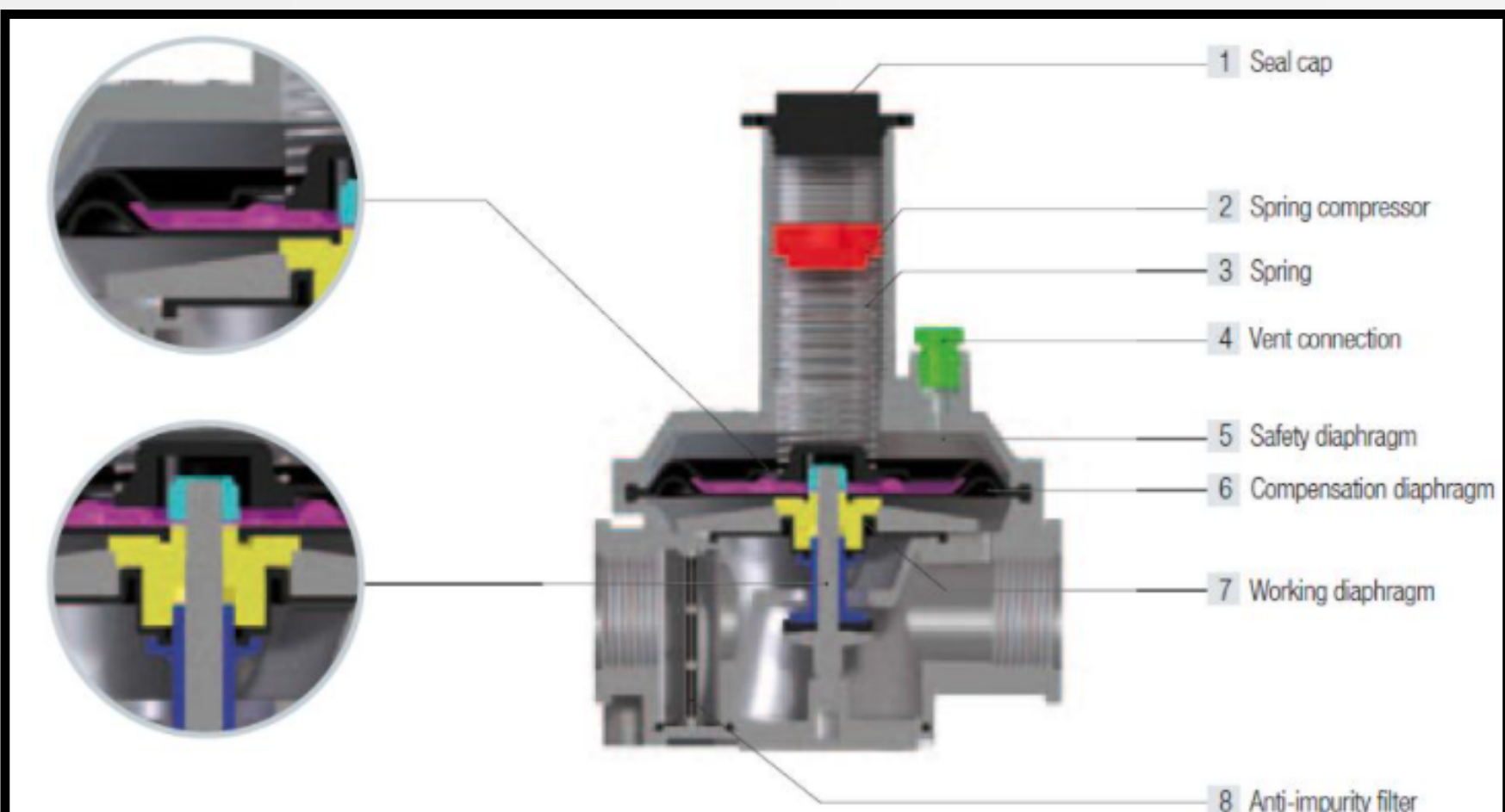

Contact Us To Know More!
012 410 3287
sales@comet-integrated

