



**Your Best Partner in Gas Appliances
& Equipment Supplies**

AUTOMATIC CHANGEOVER CATALOGUE



23, Jalan Gitar 33/3, Elite
Industrial Park, Seksyen 33,
40350 Shah Alam, Selangor



sales@comet-integrated.com



+6012 410 3287



comet-integrated.com



FUJIKOKI AUTOCHANGE OVER (RE22 & RE30)

AUTOCHANGE

These autochange regulators switch smoothly from one gas supply to the backup when the primary runs low, ensuring continuous, uninterrupted gas flow without manual operation.



MODEL	RE22
Capacity BTU/h - kg/h based on Propane 100%	954,000 BTU/h 20 kg/h
Inlet Pressure	15 – 227Psig 0.1 – 1.56MPa
Outlet Pressure	4.7 – 12Psig 0.032 – 0.083MPa
Maximum Blockage Pressure	13.8Psig or below 0.095MPa or below
Inlet Connection	1/2" BSPT Female
Outlet Connection	1/2" BSPT Female
Width (mm)	L=188±5



MODEL	RE30
Capacity BTU/h - kg/h based on Propane 100%	1,575,000 BTU/h 33 kg/h
Inlet Pressure	15 – 227Psig 0.1 – 1.56MPa
Outlet Pressure	4.7 – 12Psig 0.032 – 0.083MPa
Maximum Blockage Pressure	13.8Psig or below 0.095MPa or below
Inlet Connection	1/2" BSPT Female
Outlet Connection	1/2" BSPT Female
Width (mm)	L=188±5



FUJIKOKI AUTOCHANGE OVER WITH SECOND STAGE REGULATOR (RF21 & RF30)

AUTOCHANGE with SECOND STAGE REGULATOR

Both the RF21 and RF33 are part of the RF series, designed as low-pressure, single-step gas change-over regulators. They reduce inlet pressure directly to their operating output without an intermediate (first-stage) reduction. Maintains stable gas pressure, improving appliance safety and performance.



MODEL	RF21
Capacity BTU/h - kg/h based on Propane 100%	954,000 BTU/h 20 kg/h
Inlet Pressure	15 – 227Psig 0.1 – 1.56MPa
Outlet Pressure	0.37 – 0.487Psig 2.55 – 3.30kPa
Maximum Blockage Pressure	0.5Psig or below 3.5kPa or below
Inlet Connection	1/2" BSPT Female
Outlet Connection	1/2" BSPT Female
Width (mm)	L=188±5 H=148±5



MODEL	RF30
Capacity BTU/h - kg/h based on Propane 100%	1,575,000 BTU/h 30 kg/h
Inlet Pressure	15 – 227Psig 0.1 – 1.56MPa
Outlet Pressure	0.37 – 0.487Psig 2.55 – 3.30kPa
Maximum Blockage Pressure	0.5Psig or below 3.5kPa or below
Inlet Connection	1/2" BSPT Female
Outlet Connection	1/2" BSPT Female
Width (mm)	L=188±5 H=342±5



**FUJIKOKI
AUTOCHANGE OVER
& AUTOCHANGE
OVER WITH SECOND
STAGE REGULATOR
(RE50F & RF50F)**

AUTOCHANGE

The RE50F capacity is 50KG. It is part of the medium-pressure series, also provides automatic change-over while delivering stable pressure for larger gas systems that require reliable, continuous performance.



MODEL	RE50F
Capacity BTU/h - kg/h based on Propane 100%	2,386,000 BTU/h 50 kg/h
Inlet Pressure	15 – 227Psig 0.1 – 1.56MPa
Outlet Pressure	4.7 – 12Psig 0.032 – 0.083MPa
Maximum Blockage Pressure	13.8Psig or below 0.095MPa or below
Inlet Connection	1/2" BSPT Female
Outlet Connection	3/4" BSPT Female
Width (mm)	L=330±5

AUTOCHANGE with SECOND STAGE REGULATOR

The RF50F capacity is 50kg. It is low-pressure, single-step model that automatically switches between gas sources while regulating pressure in one stage, making it easy to install. Ideal for LPG and propane systems.



MODEL	RF50F
Capacity BTU/h- kg/h based on Propane 100%	2,386,000 BTU/h 50 kg/h
Inlet pressure	15 - 227Psig 0.1 - 1.56MPa
Outlet pressure	4.7 - 12Psig 0.032 - 0.083MPa
Maximum blockage pressure	13.8Psig or below 0.095MPa or below
Inlet Connection	1/2" BSPT Female
Outlet Connection	3/4" BSPT Female
Width (mm)	L=330±5



CLESSE AUTOMATIC CHANGE OVER (126 & 175C)



Clesse Automatic Change Over

It is a device used with 2 LPG cylinder banks called "service" and "reserve" banks. The automatic changeover firstly takes gas from the service bank until fully depleted, and will automatically change to the reserve bank. An indicator will show that the service bank is empty.

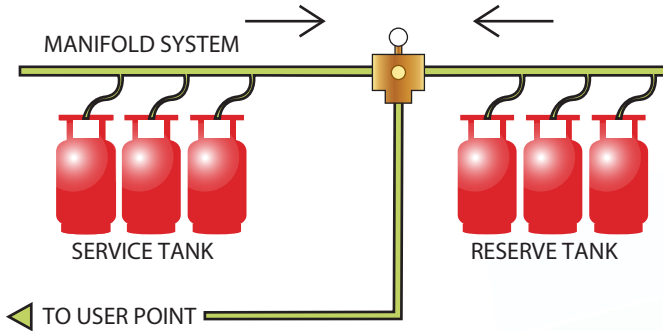

Benefits:

1. It provides a continuous flow of gas which eliminates the risk of affecting production and performance of machines.
2. Excellent change-over performances. The large pressure gap between "service" and "reserve" (more than 15% of nominal regulated pressure) ensures full use of gas cylinder.

Auto Changeover 126

This first stage, high capacity automatic changeover is used for LPG cylinders or tanks. It also provides first stage regulation. It is suitable to be used in commercial, industrial or agricultural application. This product is extremely robust as it is made of brass. There are two choices of visual indicator to show empty vessel; pressure gauge or "Magiscope", a Red-White colour indicator.

Model	126
Capacity	50kg/hr 2,350,000 btu/hr
Inlet Pressure (bar)	1.7 - 20
Outlet Pressure (bar)	1.2
Inlet Connection	3/4" BSP
Outlet connection	3/4" BSP



Auto Changeover 175C

This is first stage, high pressure changeover. It has filters in both inlet connections and non-return valves to prevent any leakages. Complete with a reserve indicator built in the knob and protective wall mount casing with engraved instructions.

Model	175C
Capacity	20kg/hr 940,000 btu/hr
Inlet Pressure (bar)	3.5 - 16
Outlet Pressure (bar)	1.5 bar
Inlet Connection	1/2" NPT or 3/4" BSP available
Outlet connection	1/2" NPT or 3/4" BSP available





ITOKOKI LAX-20 LIQUID AUTOMATIC CHANGEOVER

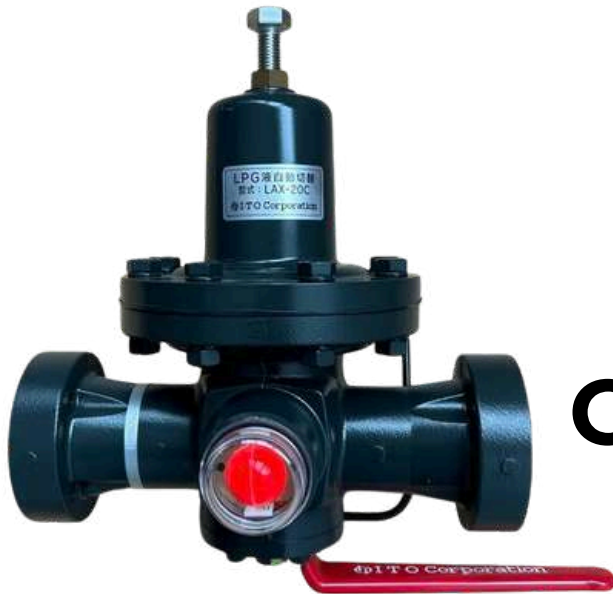

LAX-20C LIQUID AUTOMATIC CHANGEOVER

ITOKOKI Corporation was founded in Japan in 1953 and is a leading manufacturer of gas supply equipment, producing automotive switching valves, high-pressure rubber hoses, regulators, and evaporators.

The ITOKOKI LAX-20C Automatic Changeover Regulator functions to automatically switch the gas supply between LPG cylinders, ensuring a continuous and stable flow of gas without interruption when one cylinder becomes empty.

Its low changeover pressure helps reduce gas waste and maximize cylinder usage, while the clear signal indicator allows easy monitoring of the supply status. With reliable automatic operation and a compact design, it offers stable performance, easy installation, and efficient management of LPG systems.

External Dimensions

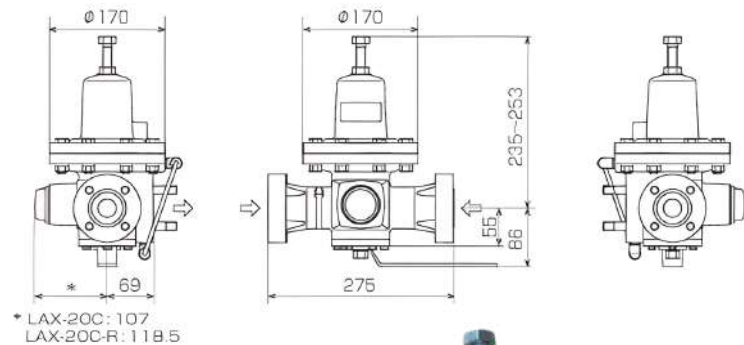

Accessories



M12 Bolt×8



Spring Washer×12
Nut×4



1/4B
Tube End Plug×1



Insert Ball for
φ6 Copper Pipe×2

Specifications

Gas Type	LPG (Liquid LPG)					
Maximum Flow Rate	300 kg/h					
Changeover Pressure	0.05~0.15MPa					
Changeover Operating Pressure Allowance	±0.01MPa					
Required Inlet Pressure (Minimum Pressure at Reserve Side)	(Changeover Pressure + ΔP) ~1.56MPa the values for ΔP are shown below:					
	Q; Flow Rate(kg/h)	100	150	200	250	300
	(MPa)	0.03	0.07	0.11	0.14	0.18
Connection	Equivalent to JIS20K20A Flange					





KAGLA LIQUID AUTO CHANGER



KAGLA LIQUID AUTO CHANGER

Compact Design

LR is micro Liquid Auto Changer which was developed by Kagla Japan Tecnology.

It's compact design with total width of (the size between flanges) only 215mm*.

Accurate Operation by Original Mechanism

"LR" is made by high precision, high reliability, high durability by "Three-way Valve: and "Snap Reverse Mechanism" with dustproof and rainproof construction. The precise operation of Kagla "LR" has obtained high evaluation around the world.

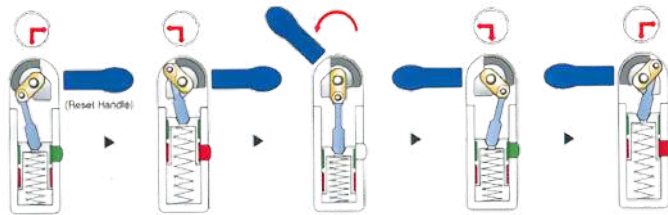

Normal Position After Changover Activated (Reset hand) Restting Changeover (Rotate Reset Handle 180 degrees) Reset Position After Another Changeover Activated

Dual Indication by "Arrow" and "Color"

Red "Arrow" indicates which line is in use, and changeover activation status can be checked by "Color" indicator. Since line use and operating status can be distinguished at a glance by the indicators. It is possible to replace cylinders correctly before short of gas.

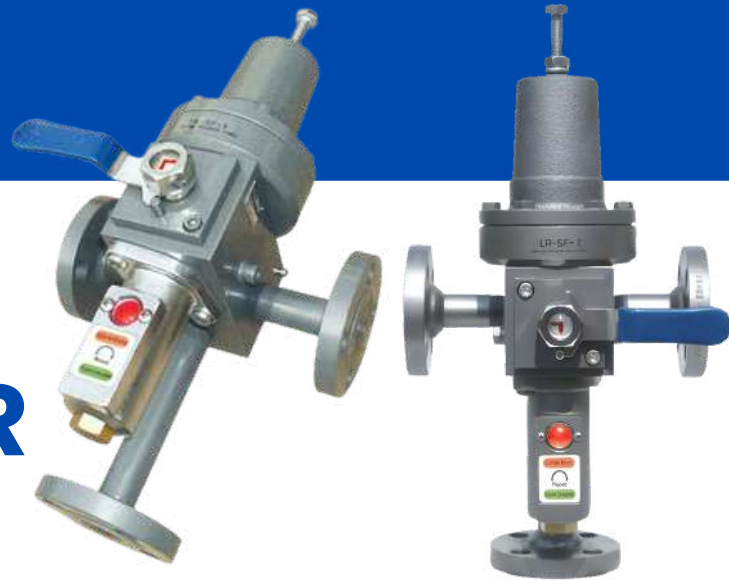
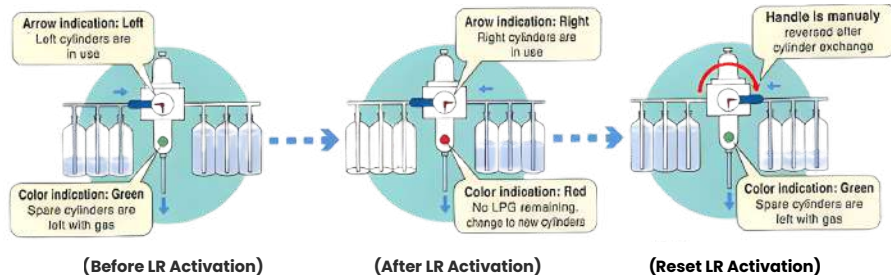

Model	Standard	LR-SF-I
Capacity		300 kg/h (Propane)
		150 kg/h (Butane)
Changeover Pressure		0.05 - 0.18MPa
Liquid Inlet, Outlet Size		JIS20K 20A
Size		W215xH425xD195mm
Weight		13 kg

Various Lineup

Kagla "LR" series respond to wide range changeover pressure from 0.05 to 0.34MPa. As we carry the model with manual changeover function and large-sized model which other companies do not have.

Model with manual changeover function

Even when performing cylinder exchange before operation of "LR", the series being used can be easily changed only by pushing the manual changeover knob.

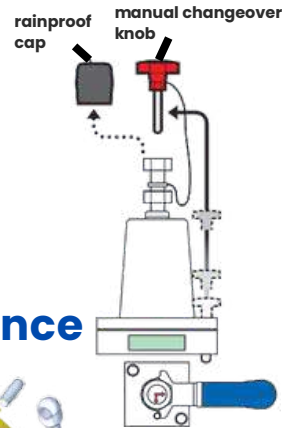

Easy Local Maintenance

"LR" is not a complex structure. It is easy to perform periodic maintenance

